

# 888 BRICKELL

DOLCE & GABBANA

M I A M I

## RESIDENCE D

FLOOR 25

### ROOMS

Bedroom  
Bathroom  
Powder Room

### SQUARE FOOTAGES (SQUARE METERS)

Indoor: 1,483 SQF (137 SM)

Outdoor: 262 SQF (24 SM)

Total: 1,745 SQF (161 SM)

### FEATURES

888 Suite & 888 Room  
Furniture by Dolce&Gabbana  
11' Ceiling Height  
Loggia & Outdoor Kitchen  
Views: North West

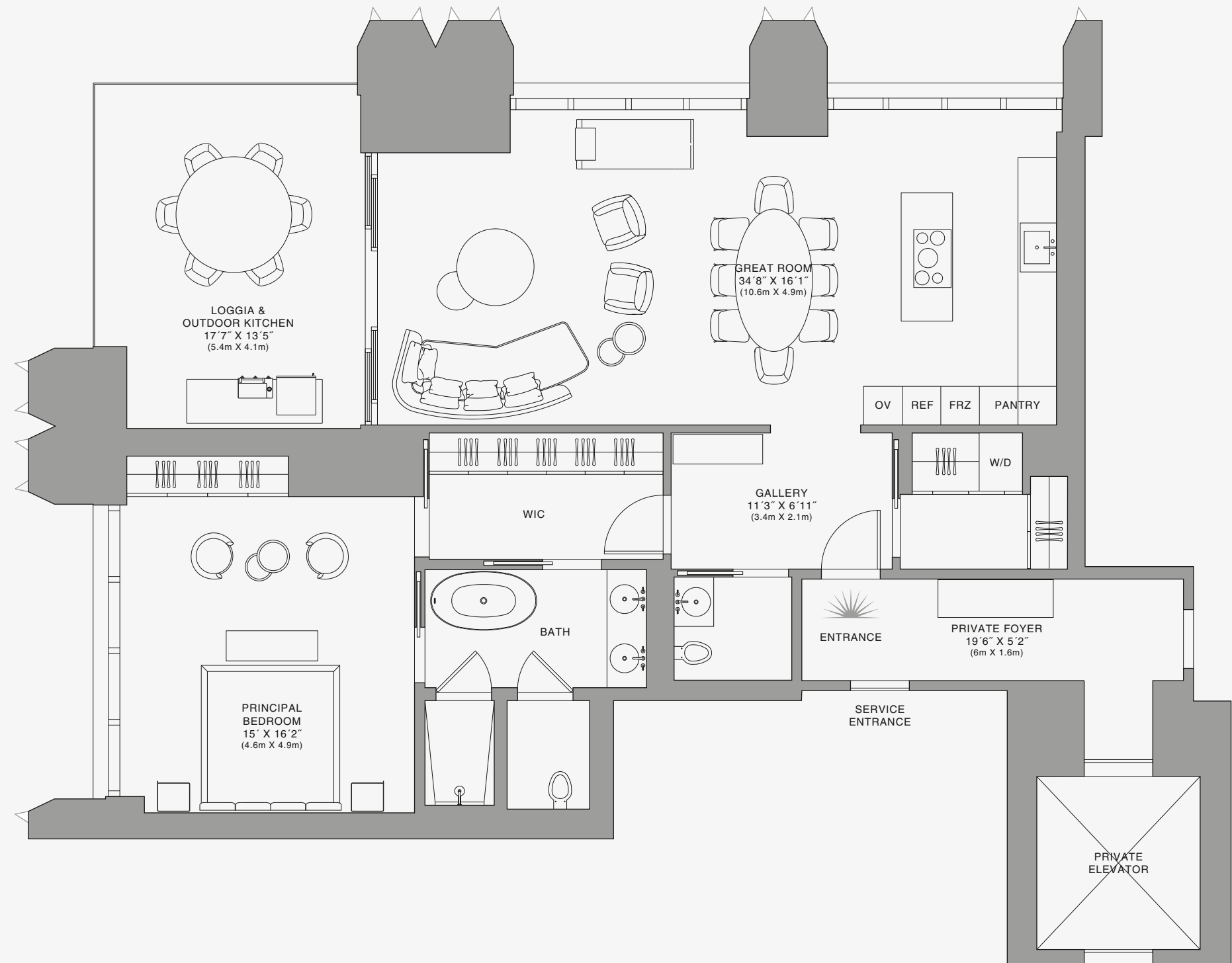
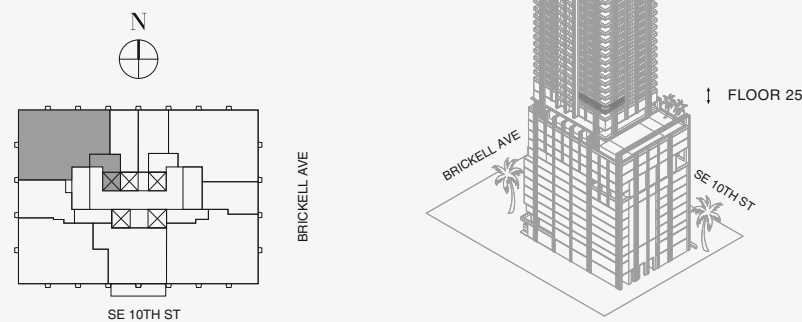

Biscayne Bay

Stated dimensions are measured to the exterior boundaries of the exterior walls and the centerline of interior demising walls and in fact vary from the dimensions that would be determined by using the description and definition of the "Unit" set forth in the Declaration (which generally only includes the interior airspace between the perimeter walls and excludes interior structural components). For your reference, the area of the Unit, determined in accordance with those defined unit boundaries, is set forth on Exhibit "3" to the Declaration of Condominium. Note that measurements of rooms set forth on this floor plan are generally taken at the greatest points of each given room (as if the room were a perfect rectangle), without regard for any cutouts. Accordingly, the area of the actual room will typically be smaller than the product obtained by multiplying the stated length times width. All dimensions are approximate and may vary with actual construction, and all floor plans and development plans are subject to change. The Condominium is not owned, developed or sold by Dolce & Gabbana S.r.l or any of its affiliates (the "Brand"). Developer uses Dolce & Gabbana marks pursuant to a license agreement with the Brand, terminable according to its terms. The Brand assumes no responsibility or liability in connection with the project, and makes no representation or warranty in respect thereof.



JDS DEVELOPMENT GROUP

info@888dolcegabbana.com

## 888 Residence



# 888 BRICKELL

DOLCE & GABBANA

M I A M I

## RESIDENCE D

FLOOR 27

### ROOMS

Bedroom  
Bathroom  
Powder Room

### SQUARE FOOTAGES (SQUARE METERS)

Indoor: 1,483 SQF (137 SM)

Outdoor: 262 SQF (24 SM)

Total: 1,745 SQF (161 SM)

### FEATURES

888 Suite & 888 Room

Furniture by Dolce&Gabbana

11' Ceiling Height

Loggia & Outdoor Kitchen

Views: North West

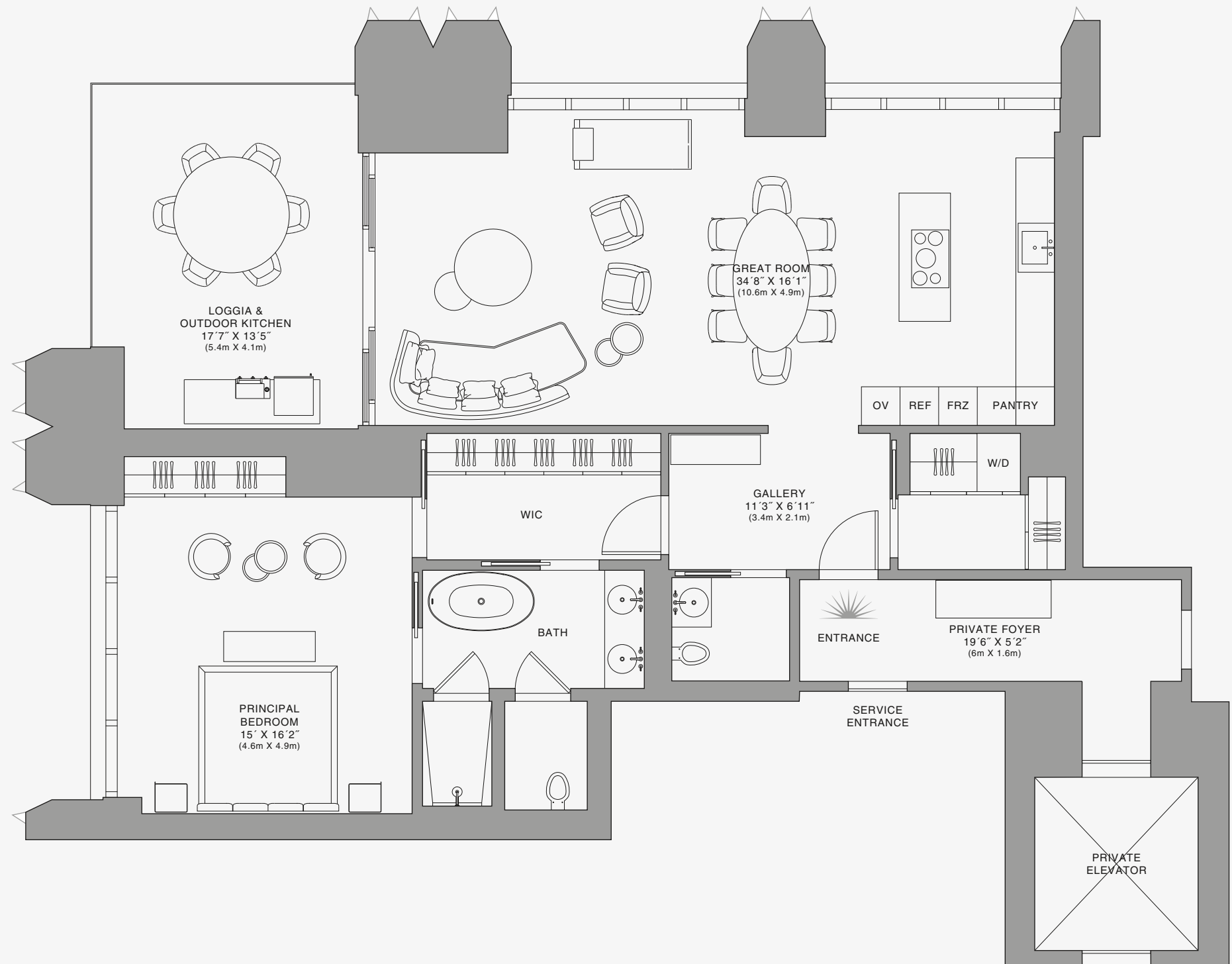
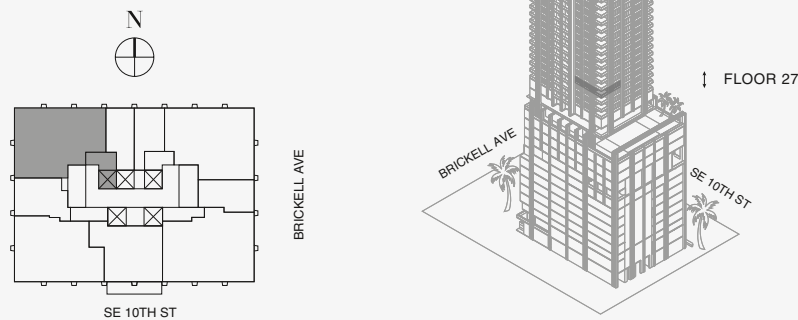

Biscayne Bay

Stated dimensions are measured to the exterior boundaries of the exterior walls and the centerline of interior demising walls and in fact vary from the dimensions that would be determined by using the description and definition of the "Unit" set forth in the Declaration (which generally only includes the interior airspace between the perimeter walls and excludes interior structural components). For your reference, the area of the Unit, determined in accordance with those defined unit boundaries, is set forth on Exhibit "3" to the Declaration of Condominium. Note that measurements of rooms set forth on this floor plan are generally taken at the greatest points of each given room (as if the room were a perfect rectangle), without regard for any cutouts. Accordingly, the area of the actual room will typically be smaller than the product obtained by multiplying the stated length times width. All dimensions are approximate and may vary with actual construction, and all floor plans and development plans are subject to change. The Condominium is not owned, developed or sold by Dolce & Gabbana S.r.l or any of its affiliates (the "Brand"). Developer uses Dolce & Gabbana marks pursuant to a license agreement with the Brand, terminable according to its terms. The Brand assumes no responsibility or liability in connection with the project, and makes no representation or warranty in respect thereof.



JDS DEVELOPMENT GROUP

info@888dolcegabbana.com

888 Residence

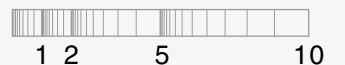

# 888 BRICKELL

DOLCE & GABBANA  
M I A M I

## RESIDENCE D

FLOOR 28

### ROOMS

Bedroom  
Bathroom  
Powder Room

### SQUARE FOOTAGES (SQUARE METERS)

Indoor: 1,483 SQF (137 SM)  
Outdoor: 262 SQF (24 SM)  
Total: 1,745 SQF (161 SM)

### FEATURES

888 Suite & 888 Room  
Furniture by Dolce&Gabbana  
11' Ceiling Height  
Loggia & Outdoor Kitchen  
Views: North West

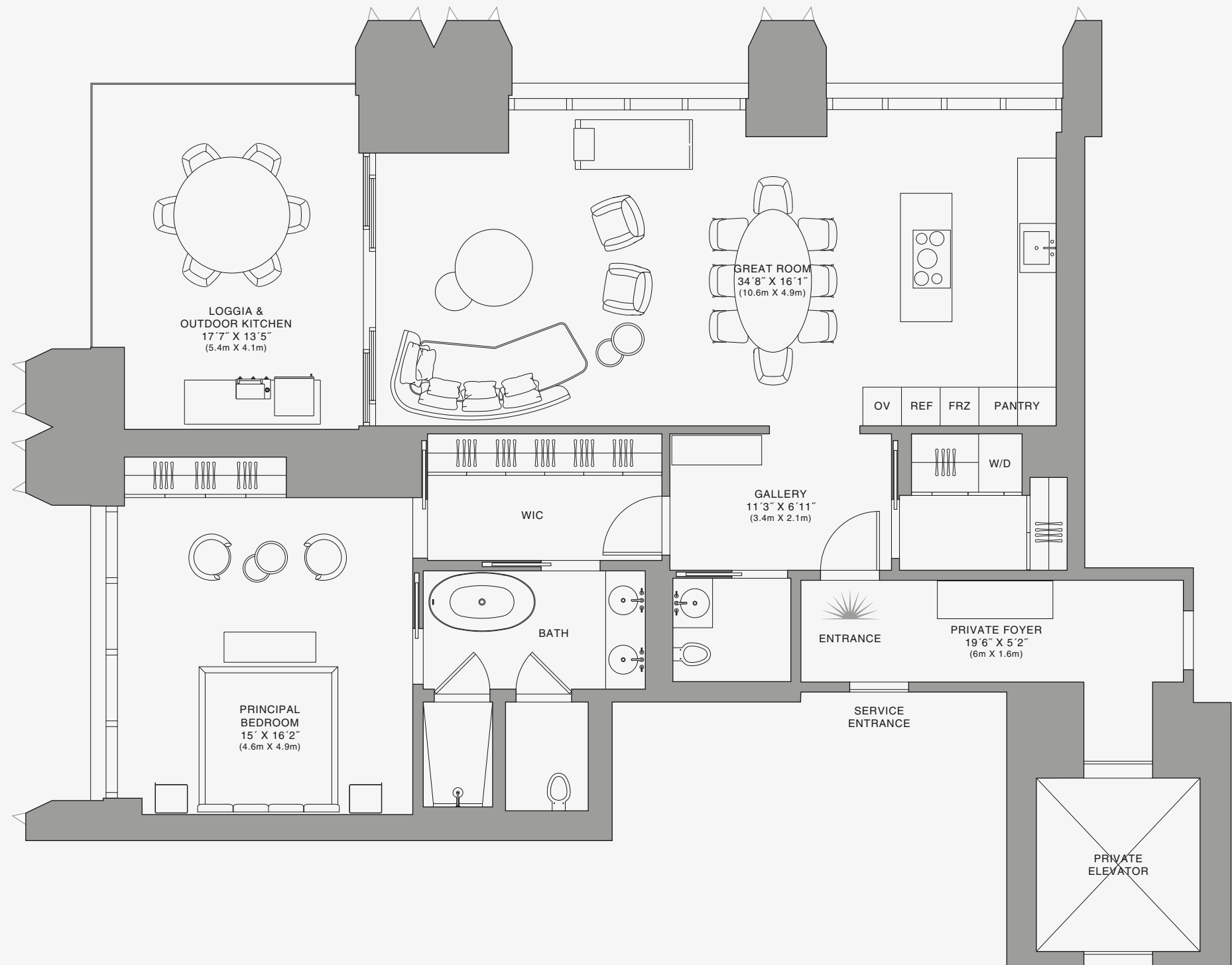
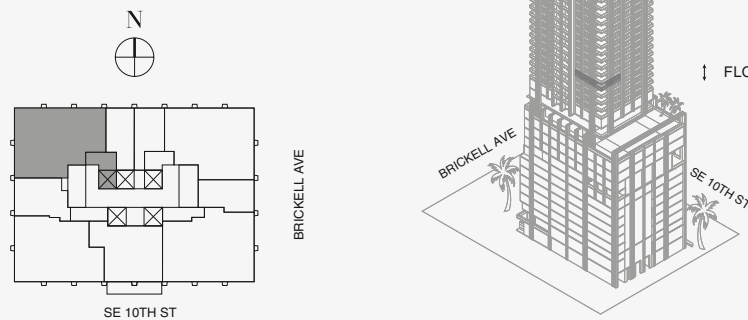

Biscayne Bay

Stated dimensions are measured to the exterior boundaries of the exterior walls and the centerline of interior demising walls and in fact vary from the dimensions that would be determined by using the description and definition of the "Unit" set forth in the Declaration (which generally only includes the interior airspace between the perimeter walls and excludes interior structural components). For your reference, the area of the Unit, determined in accordance with those defined unit boundaries, is set forth on Exhibit "3" to the Declaration of Condominium. Note that measurements of rooms set forth on this floor plan are generally taken at the greatest points of each given room (as if the room were a perfect rectangle), without regard for any cutouts. Accordingly, the area of the actual room will typically be smaller than the product obtained by multiplying the stated length times width. All dimensions are approximate and may vary with actual construction, and all floor plans and development plans are subject to change. The Condominium is not owned, developed or sold by Dolce & Gabbana S.r.l or any of its affiliates (the "Brand"). Developer uses Dolce & Gabbana marks pursuant to a license agreement with the Brand, terminable according to its terms. The Brand assumes no responsibility or liability in connection with the project, and makes no representation or warranty in respect thereof.



JDS DEVELOPMENT GROUP

info@888dolcegabbana.com

## 888 Residence



# 888 BRICKELL

DOLCE & GABBANA  
M I A M I

## RESIDENCE D

FLOOR 29

### ROOMS

Bedroom  
Bathroom  
Powder Room

### SQUARE FOOTAGES (SQUARE METERS)

Indoor: 1,483 SQF (137 SM)  
Outdoor: 262 SQF (24 SM)  
Total: 1,745 SQF (161 SM)

### FEATURES

888 Suite & 888 Room  
Furniture by Dolce&Gabbana  
11' Ceiling Height  
Loggia & Outdoor Kitchen  
Views: North West

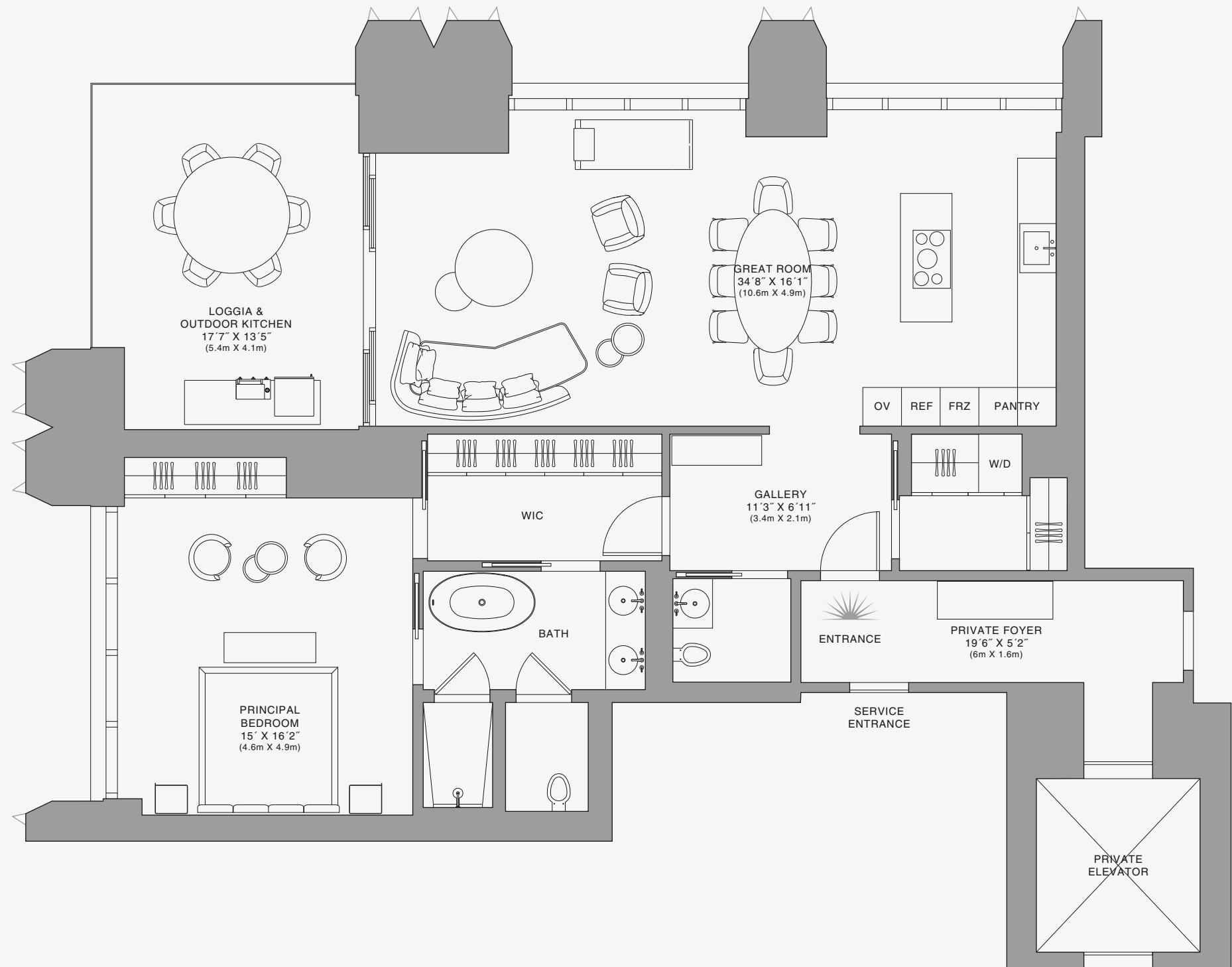
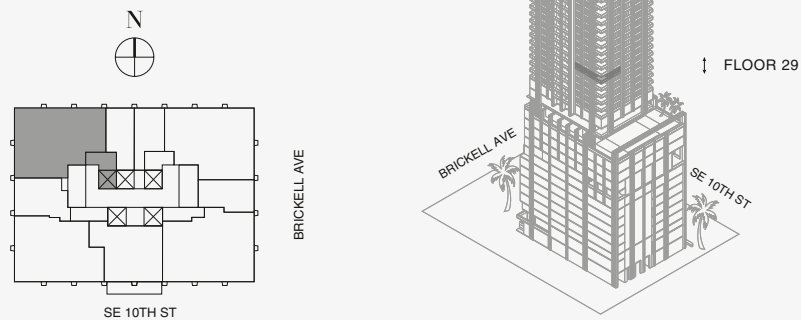

Biscayne Bay

Stated dimensions are measured to the exterior boundaries of the exterior walls and the centerline of interior demising walls and in fact vary from the dimensions that would be determined by using the description and definition of the "Unit" set forth in the Declaration (which generally only includes the interior airspace between the perimeter walls and excludes interior structural components). For your reference, the area of the Unit, determined in accordance with those defined unit boundaries, is set forth on Exhibit "3" to the Declaration of Condominium. Note that measurements of rooms set forth on this floor plan are generally taken at the greatest points of each given room (as if the room were a perfect rectangle), without regard for any cutouts. Accordingly, the area of the actual room will typically be smaller than the product obtained by multiplying the stated length times width. All dimensions are approximate and may vary with actual construction, and all floor plans and development plans are subject to change. The Condominium is not owned, developed or sold by Dolce & Gabbana S.r.l or any of its affiliates (the "Brand"). Developer uses Dolce & Gabbana marks pursuant to a license agreement with the Brand, terminable according to its terms. The Brand assumes no responsibility or liability in connection with the project, and makes no representation or warranty in respect thereof.



JDS DEVELOPMENT GROUP | info@888dolcegabbana.com

## 888 Residence



# 888 BRICKELL

DOLCE & GABBANA

M I A M I

## RESIDENCE D

FLOOR 30

### ROOMS

Bedroom  
Bathroom  
Powder Room

### SQUARE FOOTAGES (SQUARE METERS)

Indoor: 1,483 SQF (137 SM)

Outdoor: 262 SQF (24 SM)

Total: 1,745 SQF (161 SM)

### FEATURES

888 Suite & 888 Room

Furniture by Dolce&Gabbana

11' Ceiling Height

Loggia & Outdoor Kitchen

Views: North West

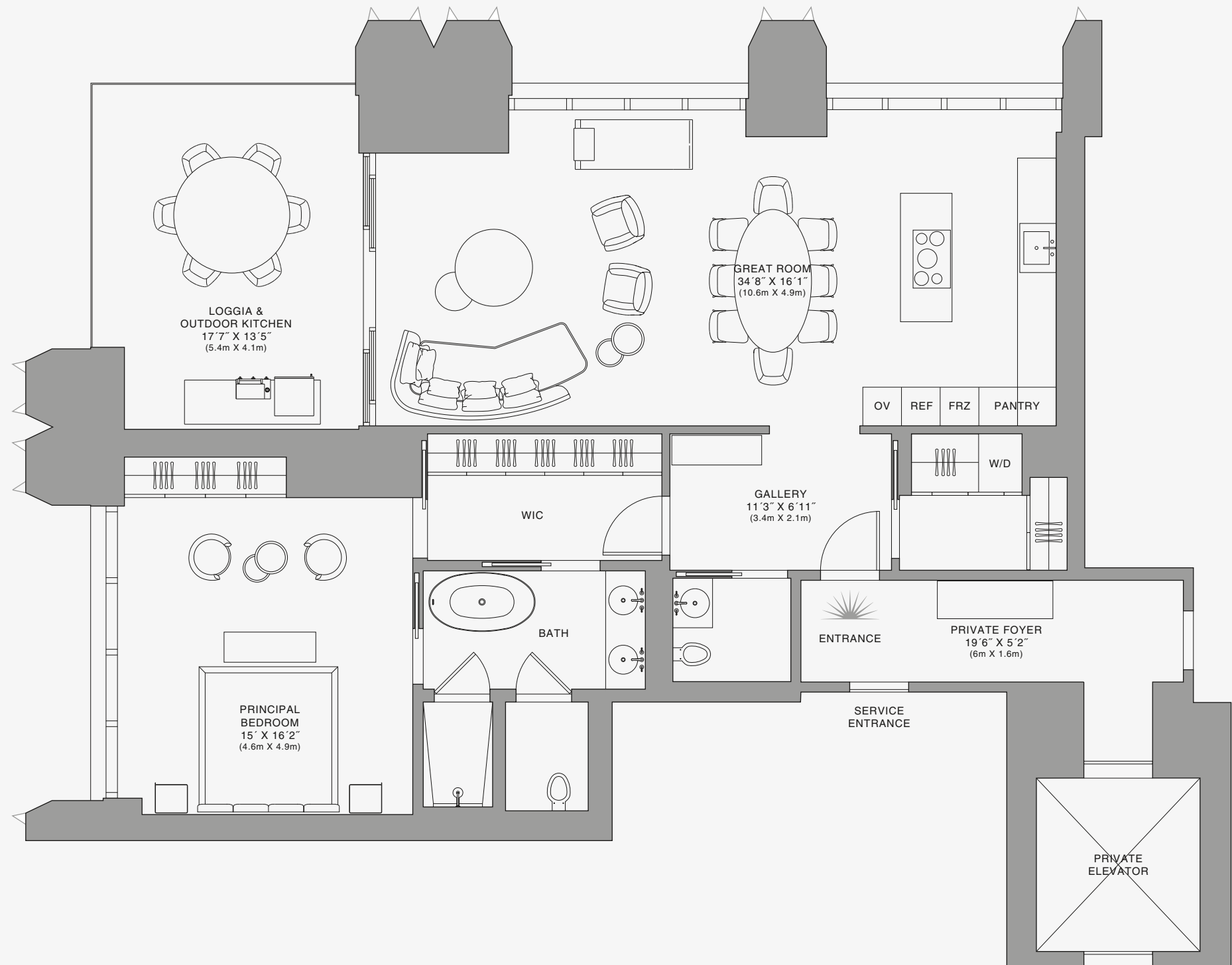
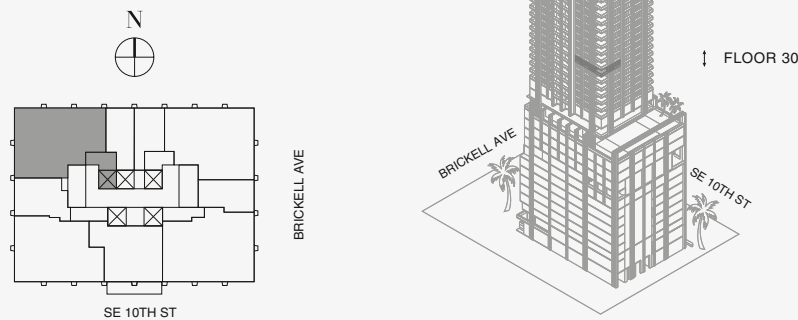

Biscayne Bay

Stated dimensions are measured to the exterior boundaries of the exterior walls and the centerline of interior demising walls and in fact vary from the dimensions that would be determined by using the description and definition of the "Unit" set forth in the Declaration (which generally only includes the interior airspace between the perimeter walls and excludes interior structural components). For your reference, the area of the Unit, determined in accordance with those defined unit boundaries, is set forth on Exhibit "3" to the Declaration of Condominium. Note that measurements of rooms set forth on this floor plan are generally taken at the greatest points of each given room (as if the room were a perfect rectangle), without regard for any cutouts. Accordingly, the area of the actual room will typically be smaller than the product obtained by multiplying the stated length times width. All dimensions are approximate and may vary with actual construction, and all floor plans and development plans are subject to change. The Condominium is not owned, developed or sold by Dolce & Gabbana S.r.l or any of its affiliates (the "Brand"). Developer uses Dolce & Gabbana marks pursuant to a license agreement with the Brand, terminable according to its terms. The Brand assumes no responsibility or liability in connection with the project, and makes no representation or warranty in respect thereof.



JDS DEVELOPMENT GROUP

info@888dolcegabbana.com

888 Residence

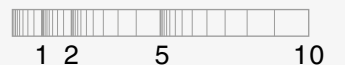

# 888 BRICKELL

DOLCE & GABBANA

M I A M I

## RESIDENCE D

FLOOR 31

### ROOMS

Bedroom  
Bathroom  
Powder Room

### SQUARE FOOTAGES (SQUARE METERS)

Indoor: 1,483 SQF (137 SM)

Outdoor: 262 SQF (24 SM)

Total: 1,745 SQF (161 SM)

### FEATURES

888 Suite & 888 Room  
Furniture by Dolce&Gabbana  
11' Ceiling Height  
Loggia & Outdoor Kitchen  
Views: North West

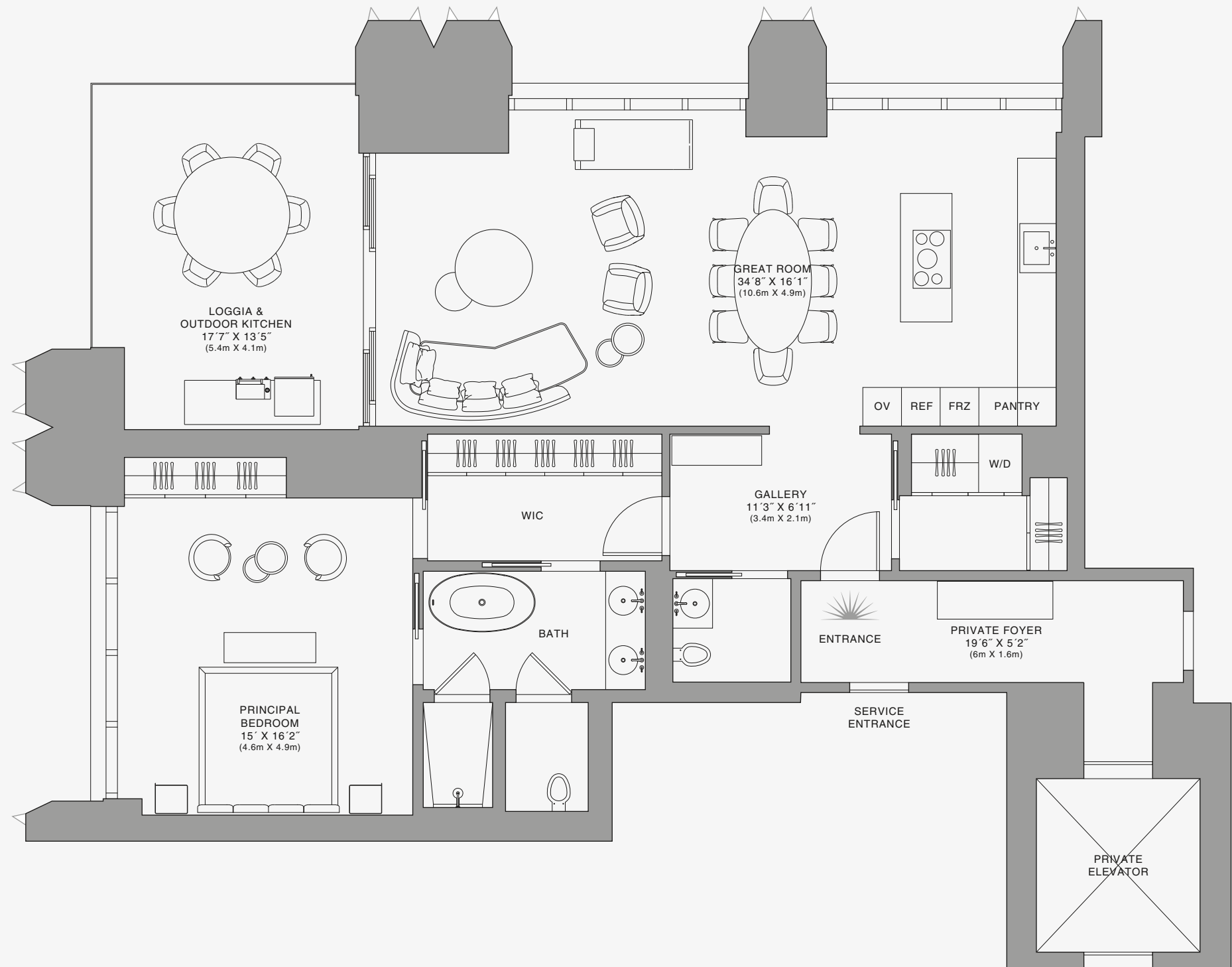
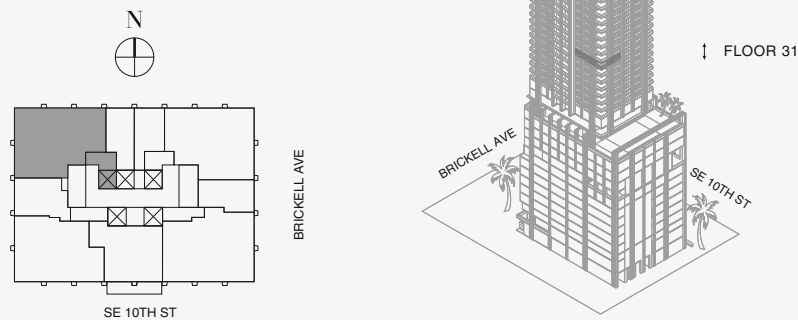

Biscayne Bay

Stated dimensions are measured to the exterior boundaries of the exterior walls and the centerline of interior demising walls and in fact vary from the dimensions that would be determined by using the description and definition of the "Unit" set forth in the Declaration (which generally only includes the interior airspace between the perimeter walls and excludes interior structural components). For your reference, the area of the Unit, determined in accordance with those defined unit boundaries, is set forth on Exhibit "3" to the Declaration of Condominium. Note that measurements of rooms set forth on this floor plan are generally taken at the greatest points of each given room (as if the room were a perfect rectangle), without regard for any cutouts. Accordingly, the area of the actual room will typically be smaller than the product obtained by multiplying the stated length times width. All dimensions are approximate and may vary with actual construction, and all floor plans and development plans are subject to change. The Condominium is not owned, developed or sold by Dolce & Gabbana S.r.l or any of its affiliates (the "Brand"). Developer uses Dolce & Gabbana marks pursuant to a license agreement with the Brand, terminable according to its terms. The Brand assumes no responsibility or liability in connection with the project, and makes no representation or warranty in respect thereof.



JDS DEVELOPMENT GROUP

info@888dolcegabbana.com

888 Residence



# 888 BRICKELL

DOLCE & GABBANA

M I A M I

## RESIDENCE D

FLOOR 33

### ROOMS

Bedroom  
Bathroom  
Powder Room

### SQUARE FOOTAGES (SQUARE METERS)

Indoor: 1,483 SQF (137 SM)

Outdoor: 262 SQF (24 SM)

Total: 1,745 SQF (161 SM)

### FEATURES

888 Suite & 888 Room

Furniture by Dolce&Gabbana

11' Ceiling Height

Loggia & Outdoor Kitchen

Views: North West

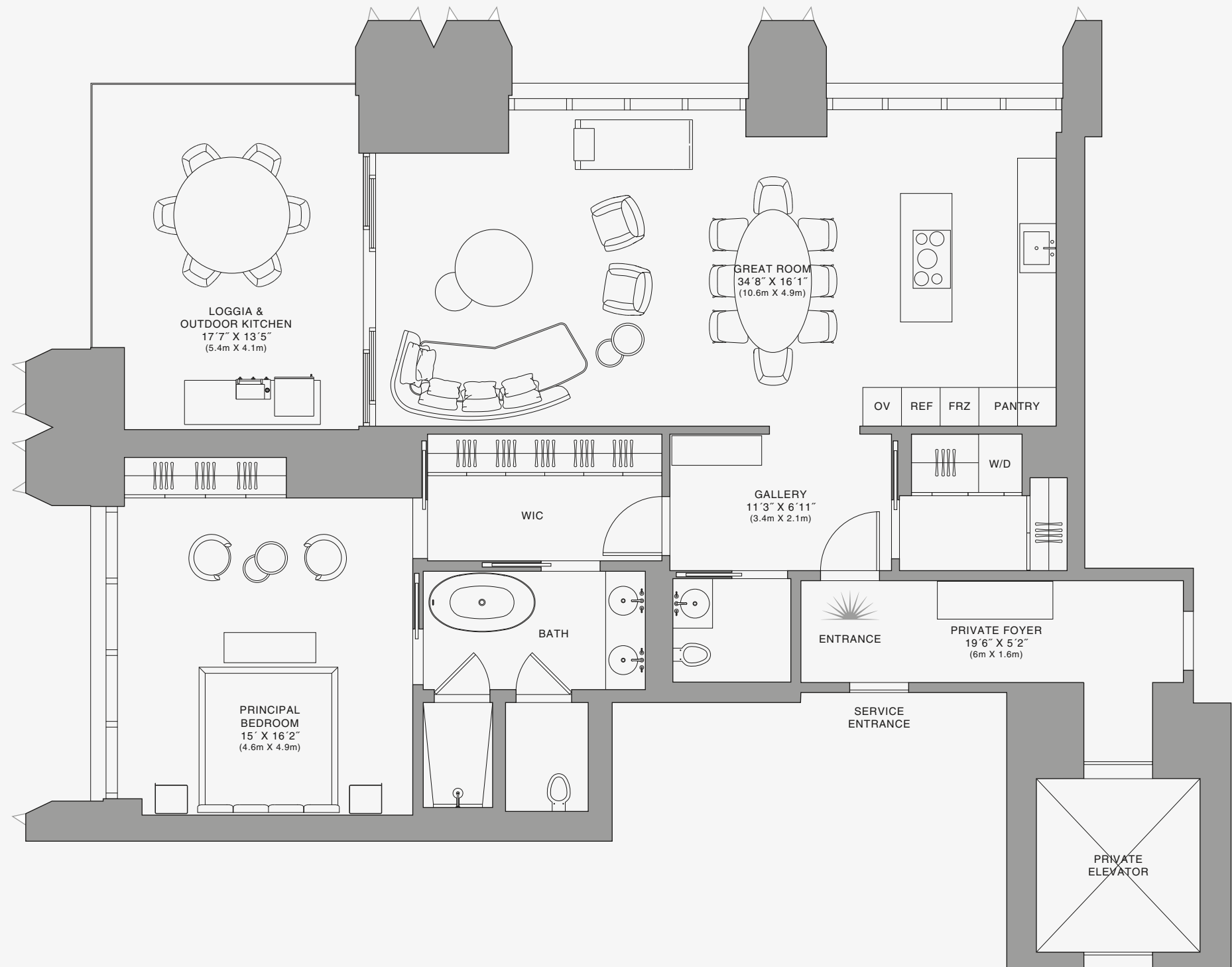
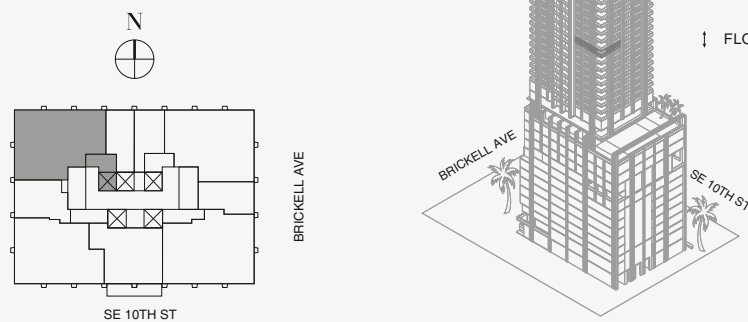

Biscayne Bay

Stated dimensions are measured to the exterior boundaries of the exterior walls and the centerline of interior demising walls and in fact vary from the dimensions that would be determined by using the description and definition of the "Unit" set forth in the Declaration (which generally only includes the interior airspace between the perimeter walls and excludes interior structural components). For your reference, the area of the Unit, determined in accordance with those defined unit boundaries, is set forth on Exhibit "3" to the Declaration of Condominium. Note that measurements of rooms set forth on this floor plan are generally taken at the greatest points of each given room (as if the room were a perfect rectangle), without regard for any cutouts. Accordingly, the area of the actual room will typically be smaller than the product obtained by multiplying the stated length times width. All dimensions are approximate and may vary with actual construction, and all floor plans and development plans are subject to change. The Condominium is not owned, developed or sold by Dolce & Gabbana S.r.l or any of its affiliates (the "Brand"). Developer uses Dolce & Gabbana marks pursuant to a license agreement with the Brand, terminable according to its terms. The Brand assumes no responsibility or liability in connection with the project, and makes no representation or warranty in respect thereof.



JDS DEVELOPMENT GROUP

info@888dolcegabbana.com

## 888 Residence



# 888 BRICKELL

DOLCE & GABBANA

M I A M I

## RESIDENCE D

FLOOR 32

### ROOMS

Bedroom  
Bathroom  
Powder Room

### SQUARE FOOTAGES (SQUARE METERS)

Indoor: 1,483 SQF (137 SM)

Outdoor: 262 SQF (24 SM)

Total: 1,745 SQF (161 SM)

### FEATURES

888 Suite & 888 Room  
Furniture by Dolce&Gabbana  
11' Ceiling Height  
Loggia & Outdoor Kitchen  
Views: North West

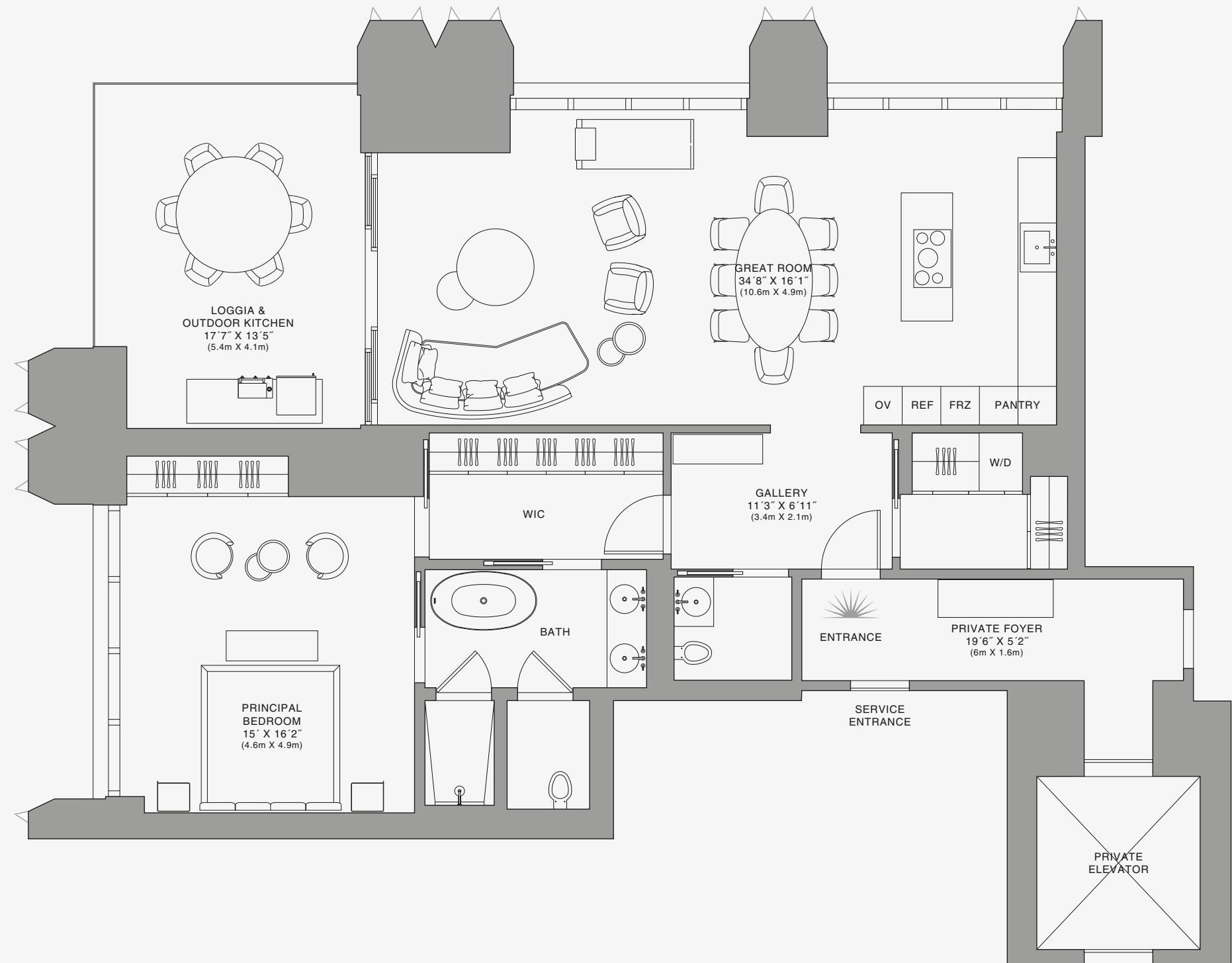
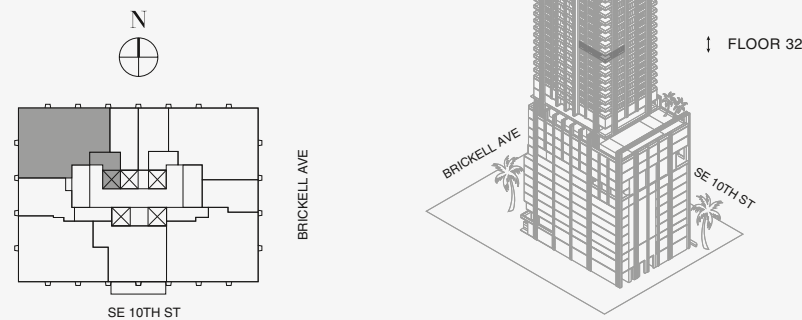

Biscayne Bay

Stated dimensions are measured to the exterior boundaries of the exterior walls and the centerline of interior demising walls and in fact vary from the dimensions that would be determined by using the description and definition of the "Unit" set forth in the Declaration (which generally only includes the interior airspace between the perimeter walls and excludes interior structural components). For your reference, the area of the Unit, determined in accordance with those defined unit boundaries, is set forth on Exhibit "3" to the Declaration of Condominium. Note that measurements of rooms set forth on this floor plan are generally taken at the greatest points of each given room (as if the room were a perfect rectangle), without regard for any cutouts. Accordingly, the area of the actual room will typically be smaller than the product obtained by multiplying the stated length times width. All dimensions are approximate and may vary with actual construction, and all floor plans and development plans are subject to change. The Condominium is not owned, developed or sold by Dolce & Gabbana S.r.l or any of its affiliates (the "Brand"). Developer uses Dolce & Gabbana marks pursuant to a license agreement with the Brand, terminable according to its terms. The Brand assumes no responsibility or liability in connection with the project, and makes no representation or warranty in respect thereof.



JDS DEVELOPMENT GROUP

info@888dolcegabbana.com

## 888 Residence

