

# Aurora

3 bd . 2 ba . 1 half ba . 1,455 ft<sup>2</sup>

1st Floor

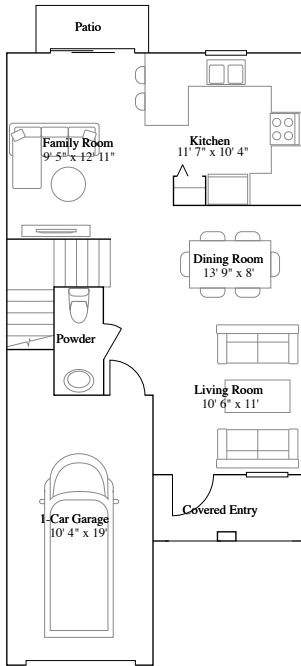

2nd Floor

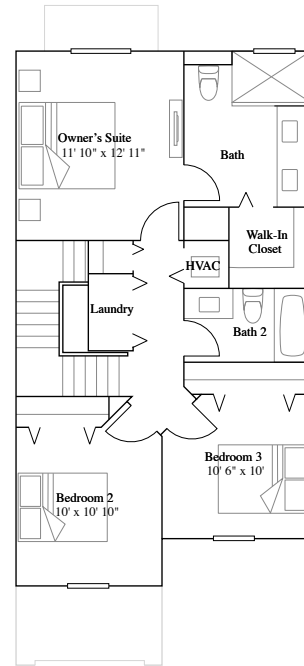

Available Exteriors



Exterior A1

Feedback

# Blossom

3 bd . 2 ba . 1 half ba . 1,697 ft<sup>2</sup>

1st Floor

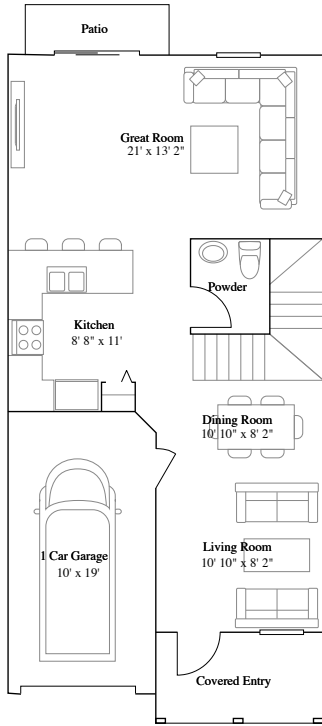

2nd Floor

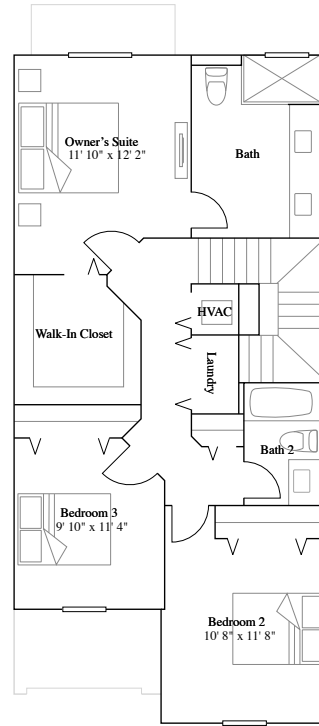

Available Exteriors



Exterior A1

Feedback

# Dahlia

3 bd . 2 ba . 1 half ba . 1,799 ft<sup>2</sup>

1st Floor

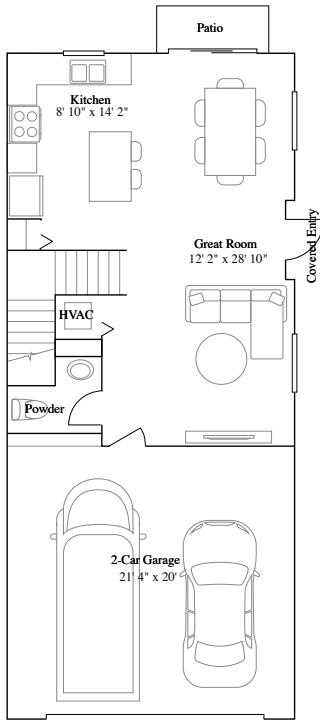

2nd Floor

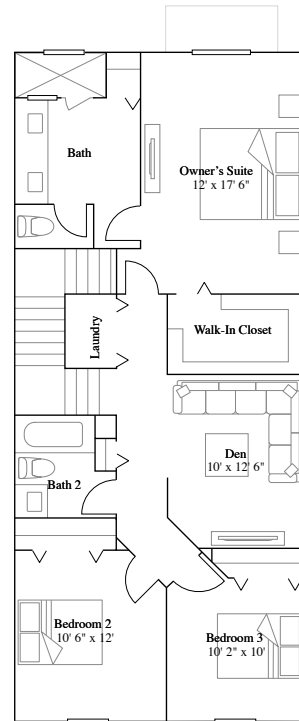

Available Exteriors



Exterior AI

# Phoenix

4 bd . 2 ba . 1 half ba . 1,828 ft<sup>2</sup>

1st Floor

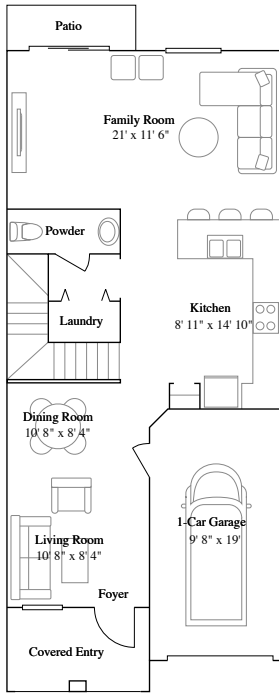

2nd Floor

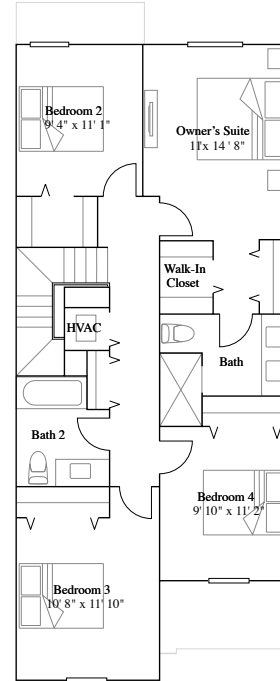

Available Exteriors



Exterior A1

# Eden

3 bd . 2 ba . 1 half ba . 1,828 ft<sup>2</sup>

1st Floor

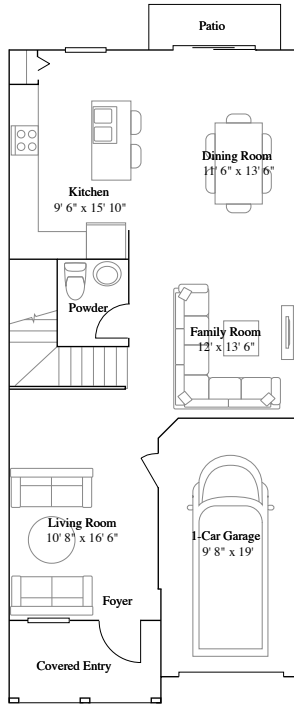

2nd Floor

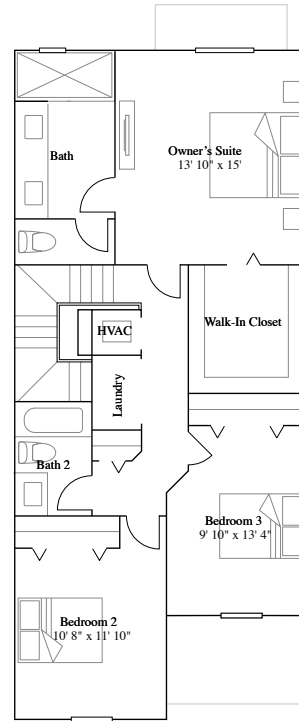

Available Exteriors



Exterior A1

Feedback

Everything included

## See all you can enjoy when everything's included

### Kitchen

New stainless steel kitchen appliance package features a modern range, microwave and refrigerator

Kitchen cabinets with 36" uppers and brushed nickel hardware

Pantry closet with ventilated shelves

Easy-care mica countertops with 6" backsplash

Stainless steel kitchen sink and decorative faucet with sprayer

Food waste disposal

Recessed down lighting

Quality stainless steel appliance package featuring: 30" smooth surface electric range with self-cleaning oven, Over-the-range built-in microwave with recirculating vent, Multi-cycle dishwasher

Feedback

### Owners Suite

Durable countertops, dual sinks and designer-selected cabinetry grace the oversized vanity in the owner's suite bathroom

A walk-in shower with glass enclosure and stylish tile surround in the owner's suite bathroom

### Secondary Bathroom

Vanity cabinets with brushed nickel hardware in all baths

Cultured marble countertops with integrated sinks and designer faucets

Bathtub in secondary bath

12"x12" Ceramic tile in all bathroom floors and shower walls

Recessed LED downlighting

Elegant pedestal sink in first floor powder room

Vanity mirror in all baths

## Interior

18" x 18" ceramic tile in kitchen, laundry, and A/C closet in a choice of decorator colors

Custom coffer ceiling in Owner's Suite

Smoke and carbon monoxide detectors throughout

Electric water heater

Central air conditioning and heating system

Rocker-style switches throughout

Plush stain resistant carpeting with padding in a choice of decorator colors in designated areas

Raised-panel interior doors

Raised panel bi-fold closet doors

Elegant interior door hardware

Designer quality paint on all walls and ceilings

Textured walls and ceilings in designated areas

Cat6 wiring in kitchen, family room and master bedroom, home run to central distribution panel

Pre-wired for ceiling fan in family or great room and all bedrooms (per plan)

## Connectivity

Ring Video Doorbell Pro

Honeywell Home T6 Pro - smart thermostat

Schlage Encode™ Smart WiFi Deadbolt